

CONNECTRUCK

My Ford Trucks Mobile Application User Manual

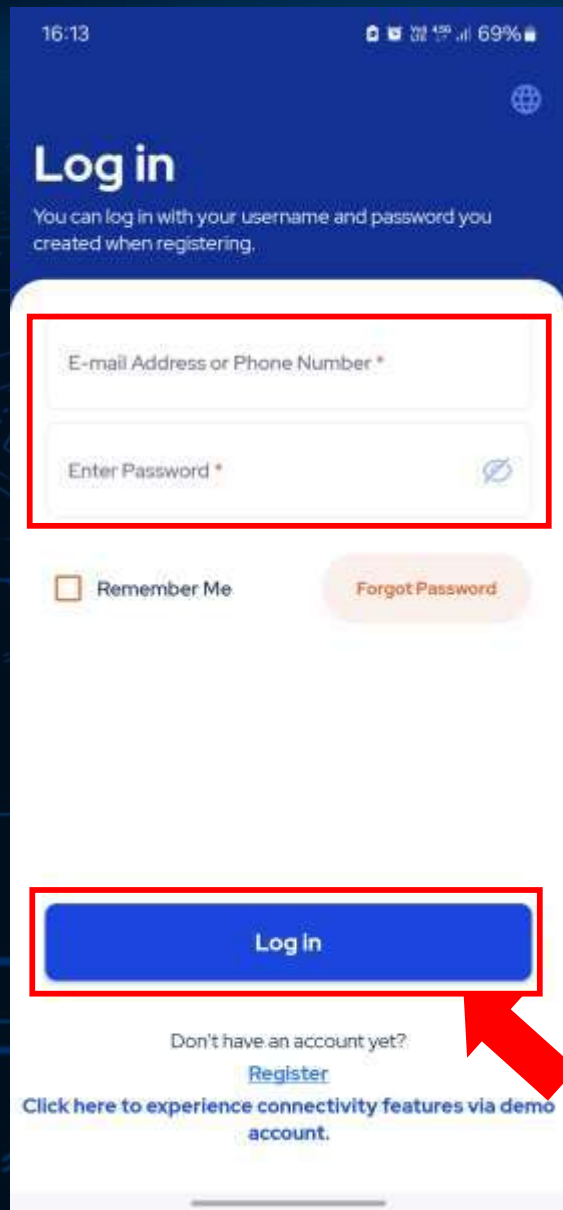

Please click on «**My Ford Trucks**» mobile app to open it.



To Access «My Ford Trucks» mobile application please insert the e-mail and the password you created at the login step and click on the «Log in» button.

CONNECTRUCK

Map Screen & Vehicle Information Card

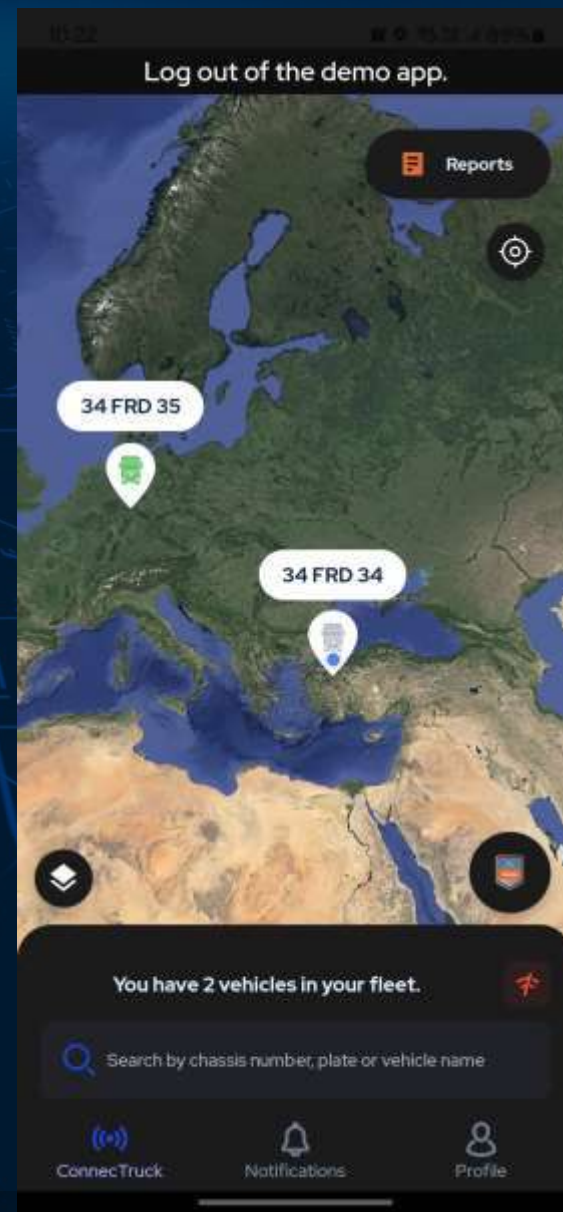
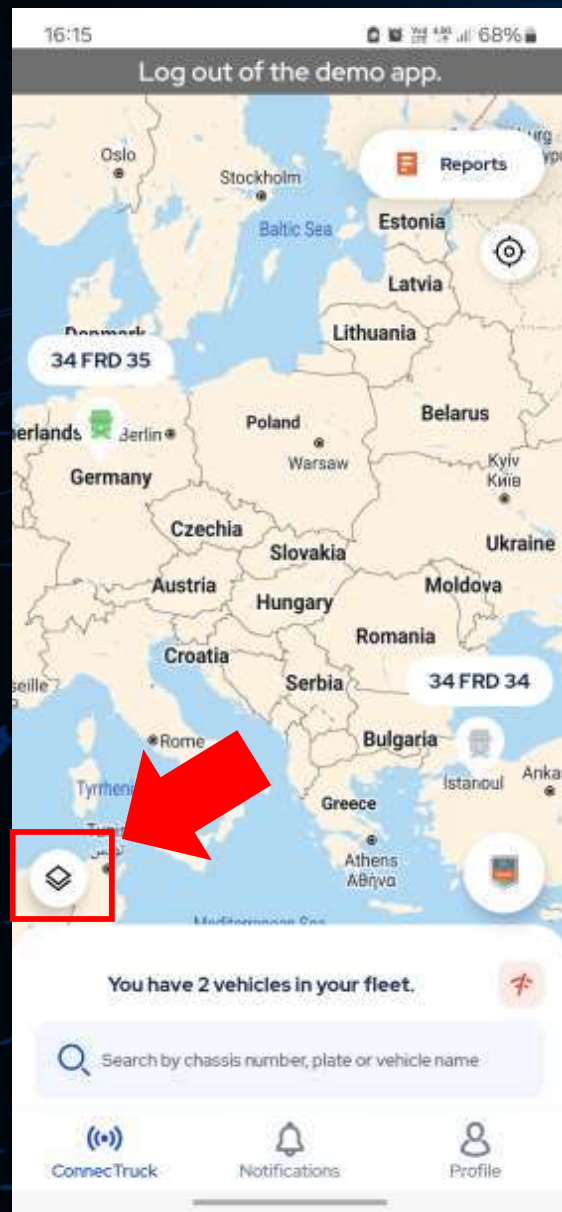

You can change the map view of the ConnectTruck by clicking the shown button.

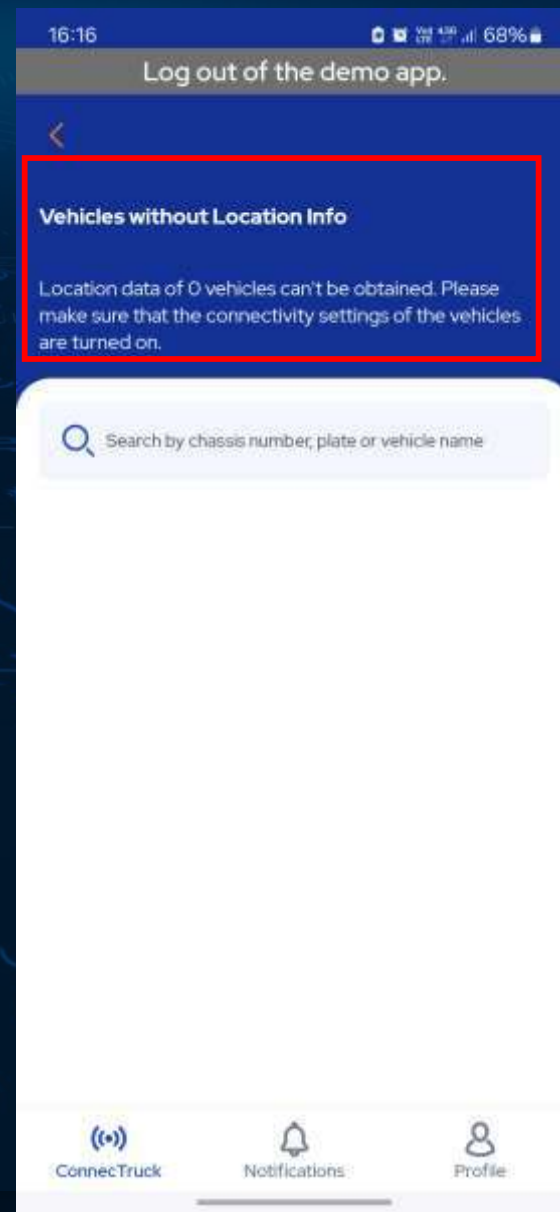

Click on the icon shown to check the vehicles in your fleet that have a ConnectTruck but whose data you cannot see. To solve your vehicle data transmission problem, you can contact your dealer.

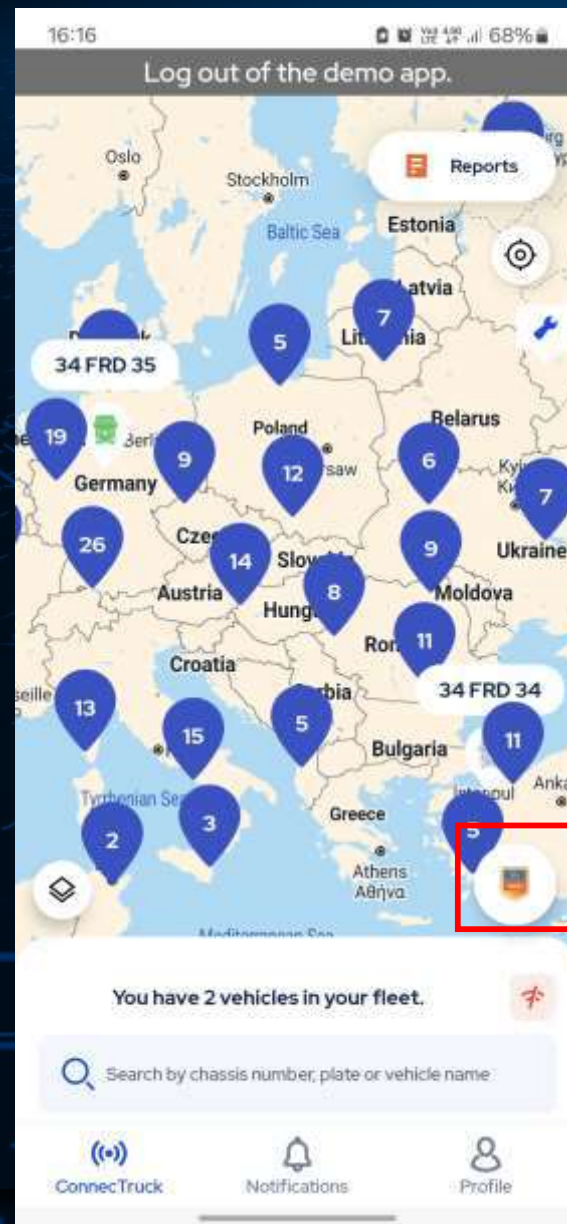

Click on the shown button to see and get navigation to the service points worldwide.

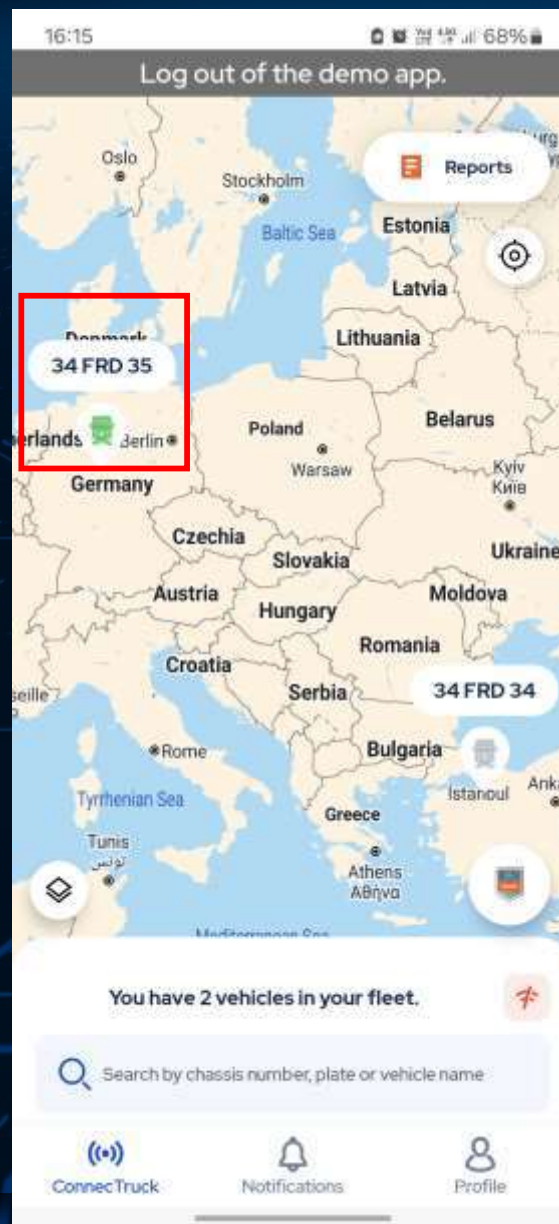

Green vehicles means they have live connection at that time.

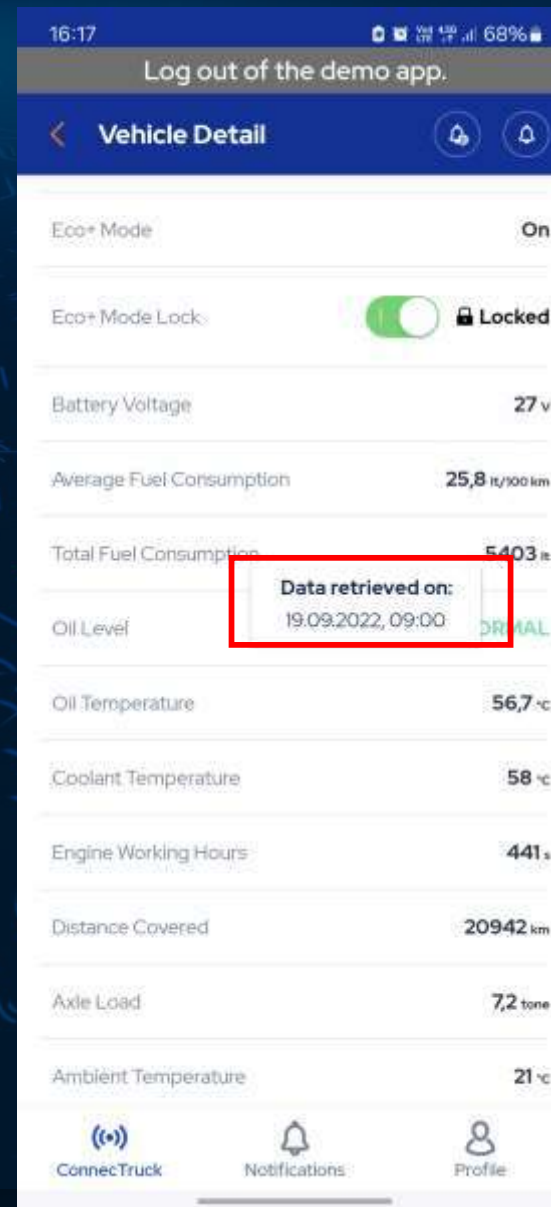
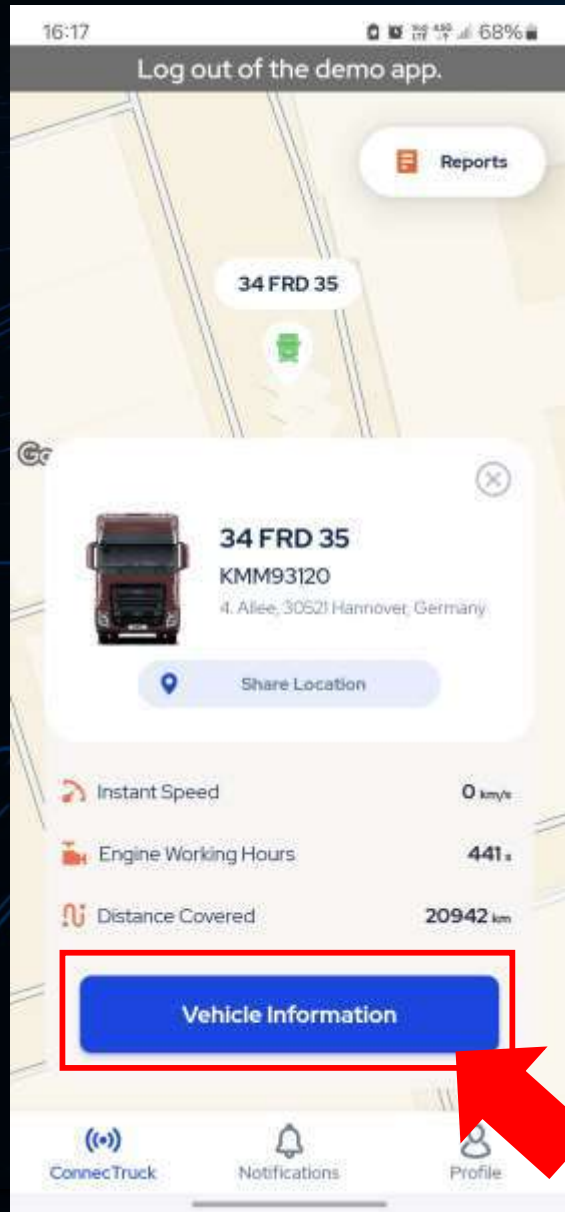

To view your vehicle's data, click on the vehicle icon and click the "Vehicle Information" button. To view the date when the relevant data was last retrieved from the vehicle, you can open the "Last data retrieved" window by clicking on the related data line.

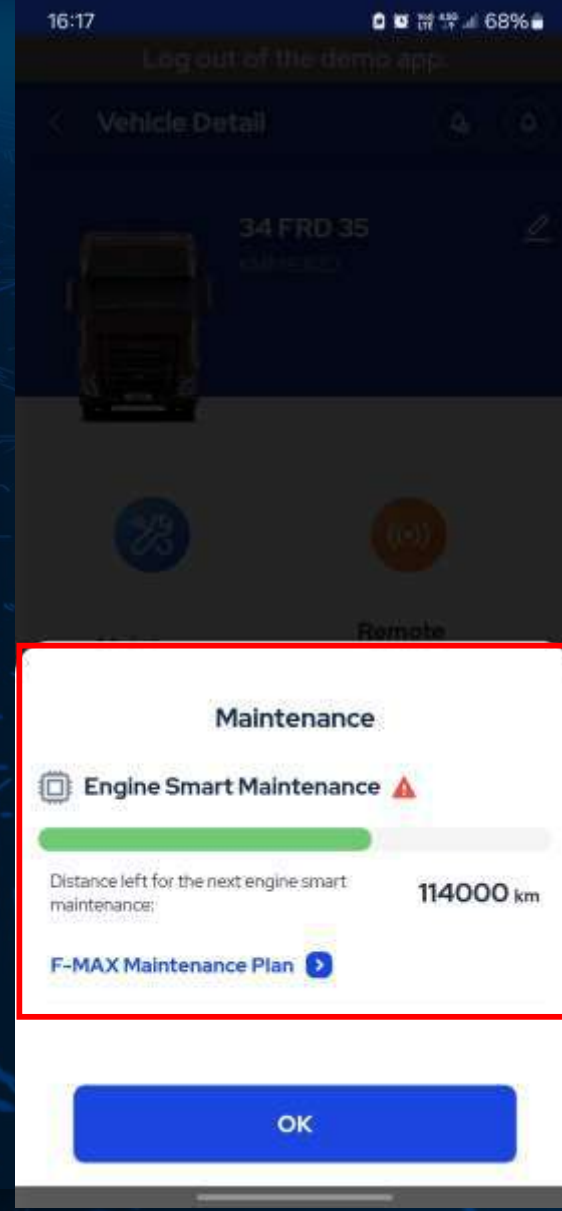
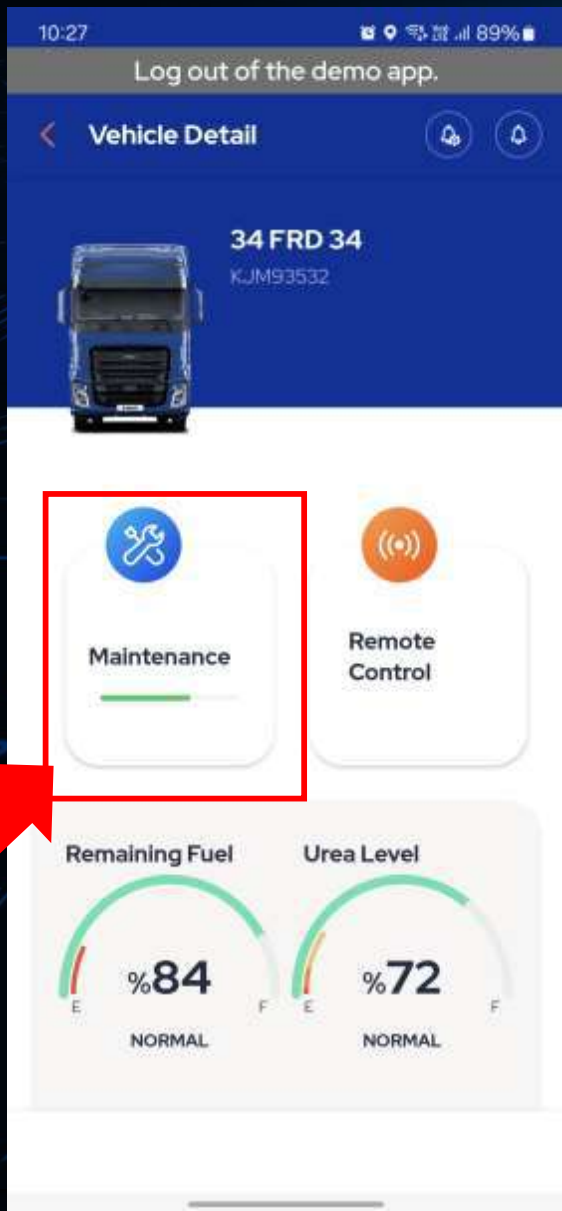

Click the "Maintenance Status" button to view the maintenance status of your vehicle. In the window that opens, you can view the remaining distance to your vehicle's smart maintenance and your maintenance plan.

CONNECTRUCK

Remote Control

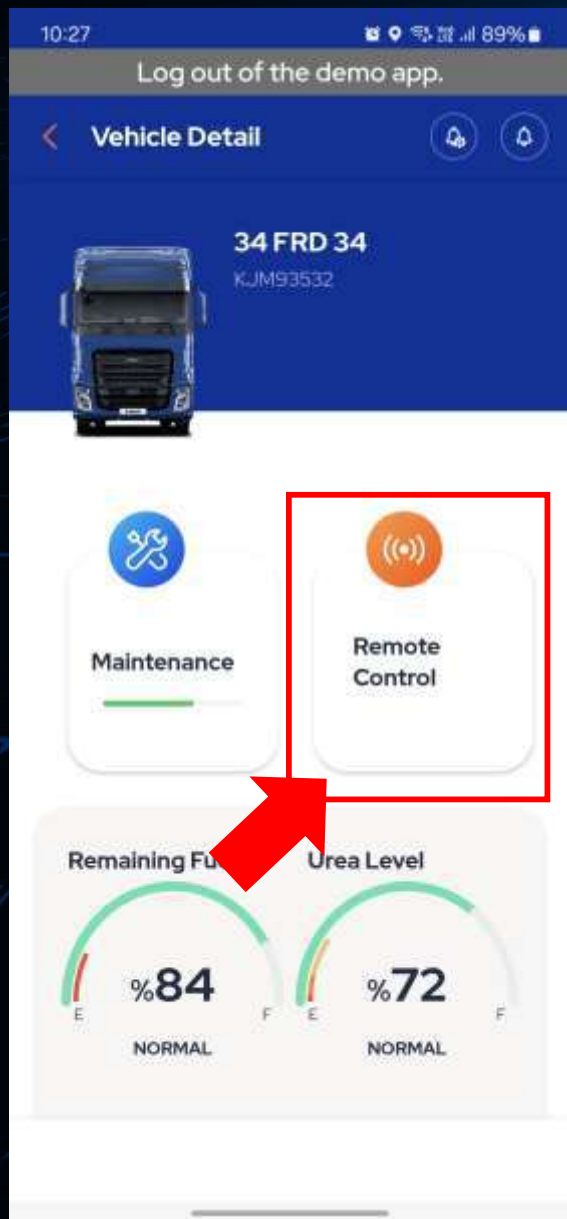

To control your vehicle remotely, click the "**Remote Control**" button. To control your vehicle remotely, you must first pair the application with your vehicle. If you meet the conditions of the pairing process, the pairing process will be completed successfully. If you do not meet the pairing conditions, you will see the relevant warning on the screen.

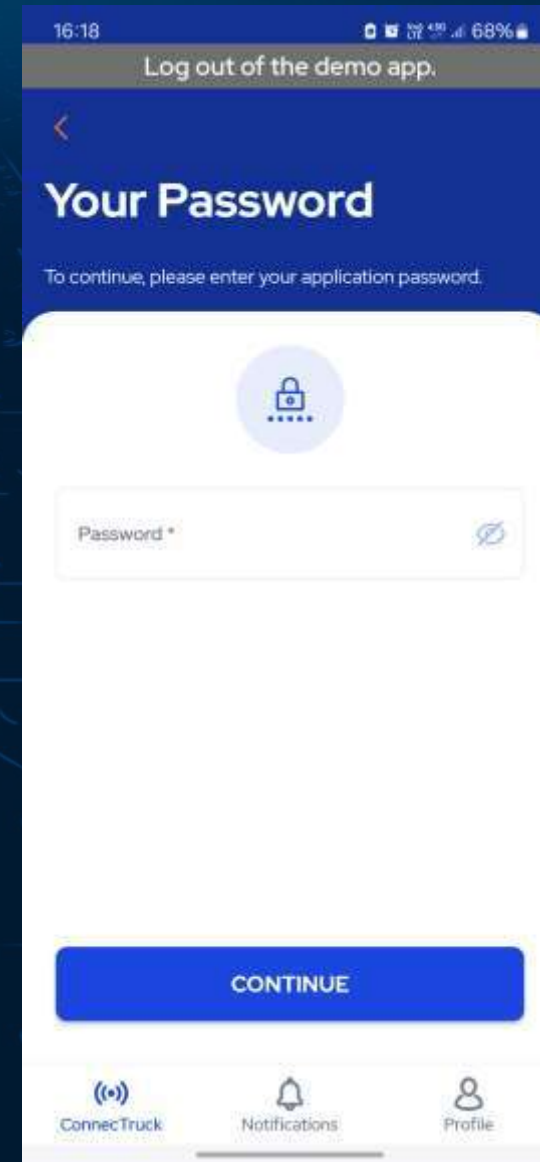
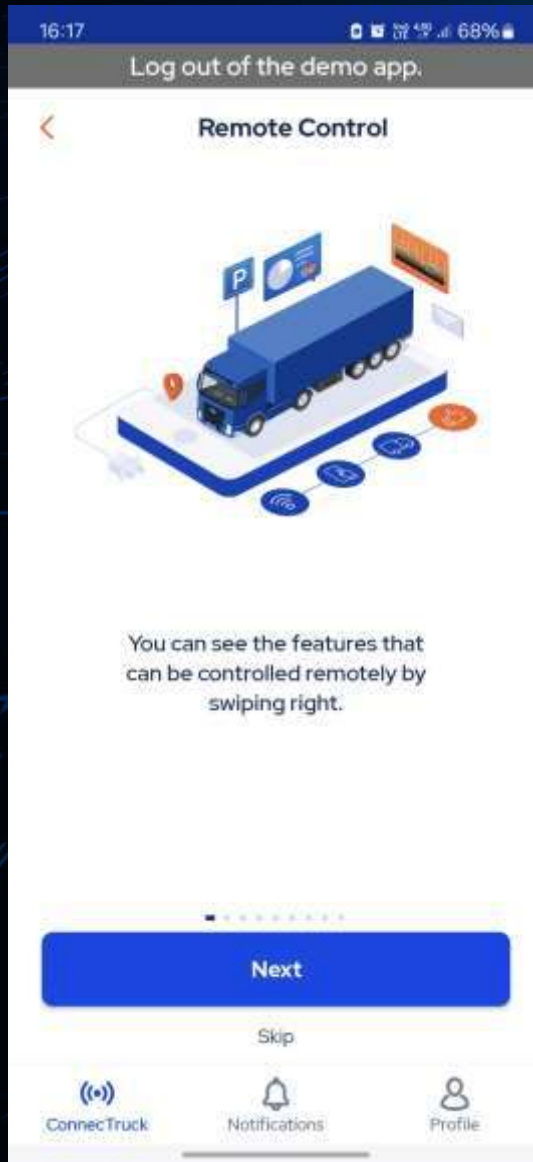

You can review the on boarding pages explaining the general flow of the remote control by clicking the "Next" button. You can switch to the remote control screen by clicking the "Skip" button.

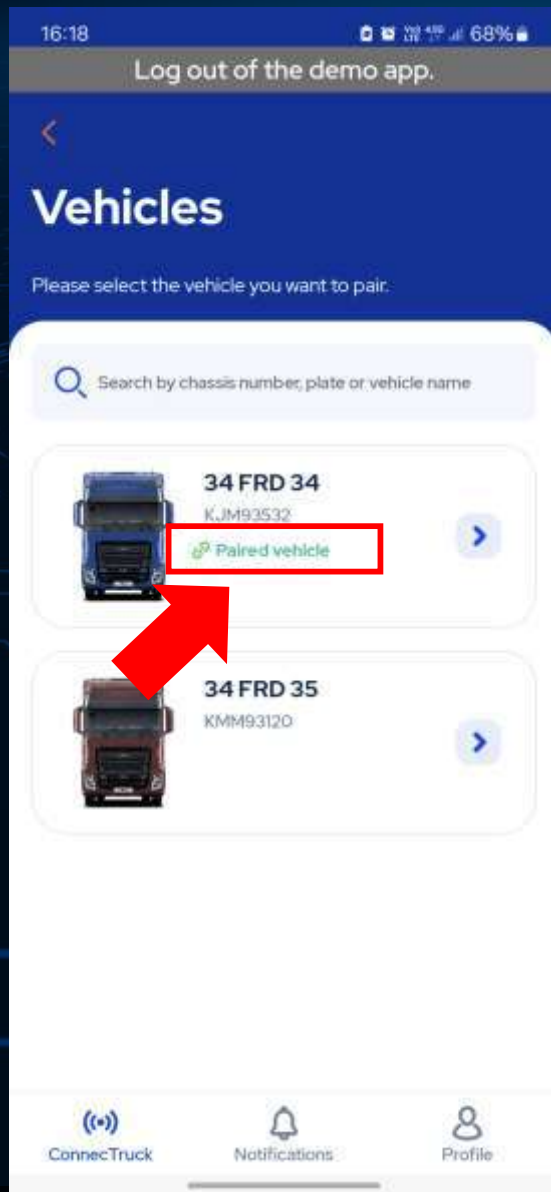

After completing your pairing process, your paired vehicle will look like the image shown.

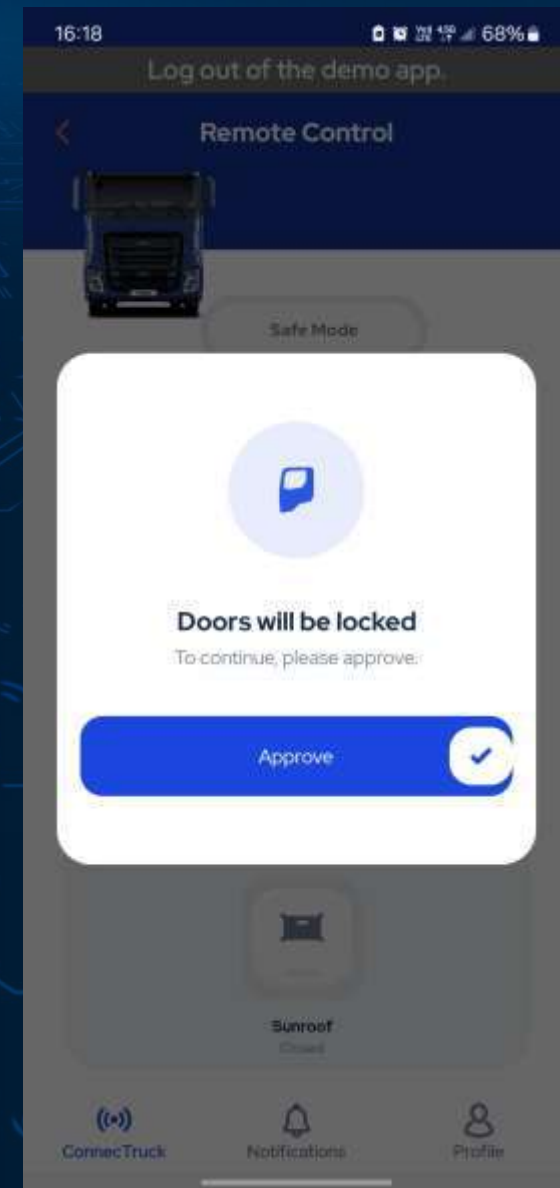
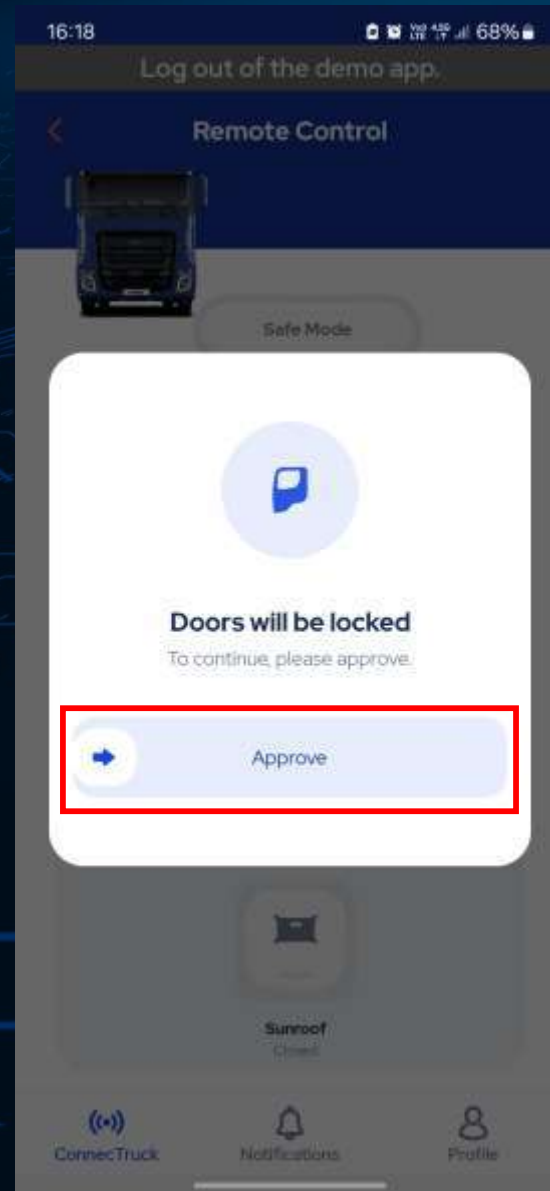
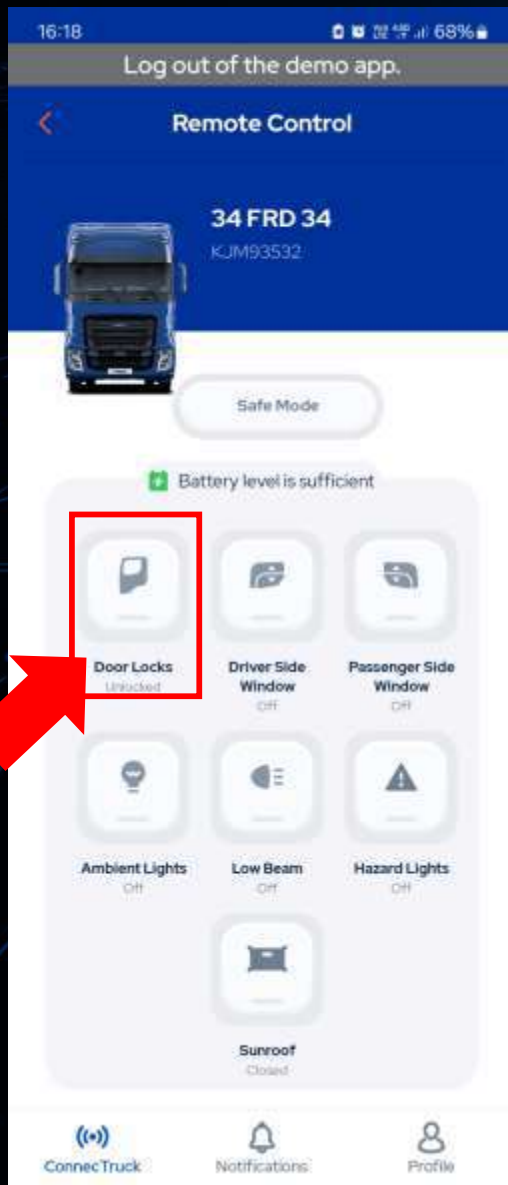

Click on the function you want to control remotely and drag the arrow sign saying "Confirm" to the right.

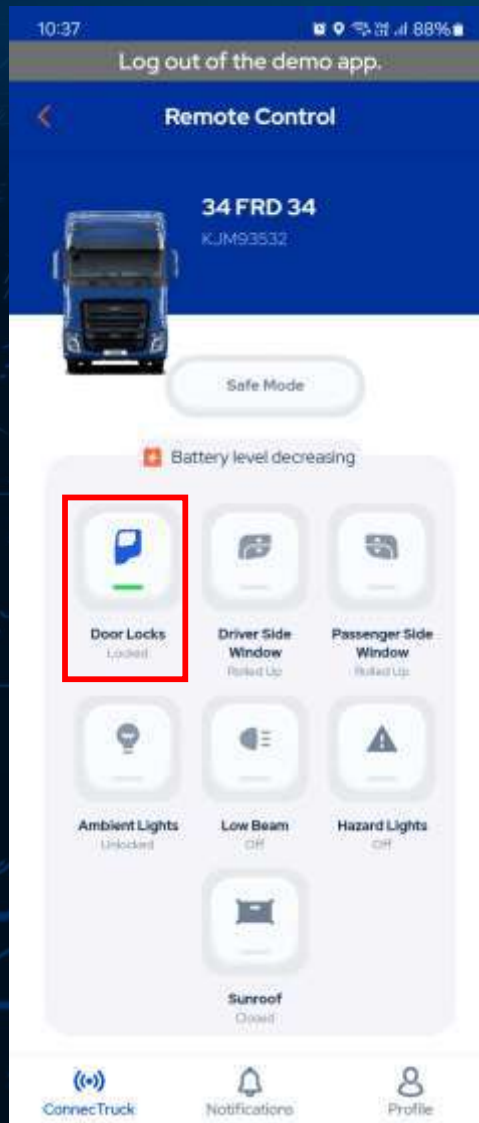

Once the feature is on you will see it in color green.

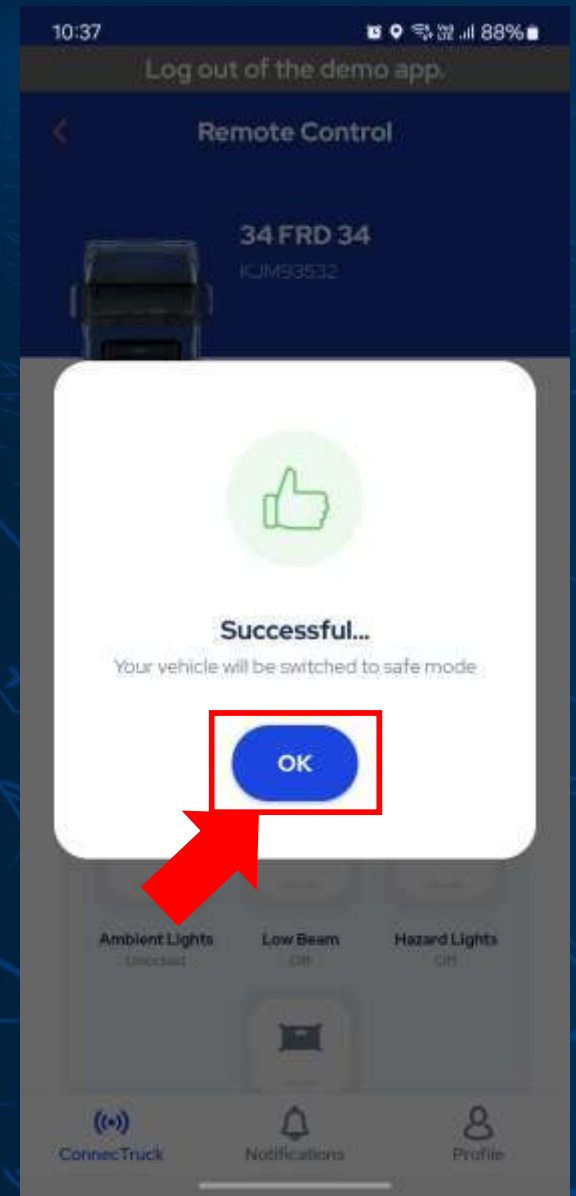
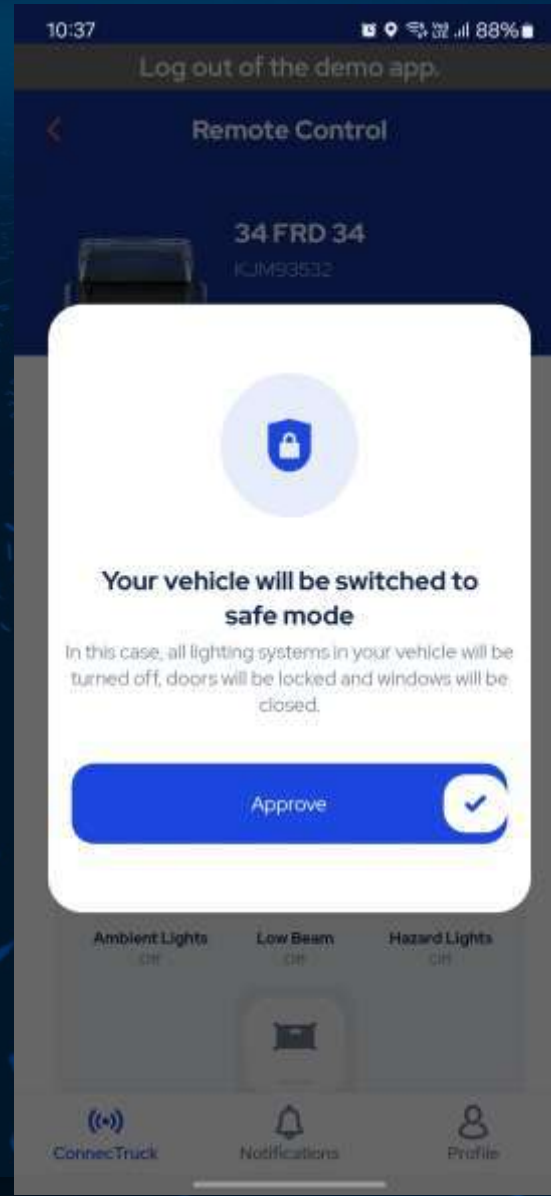
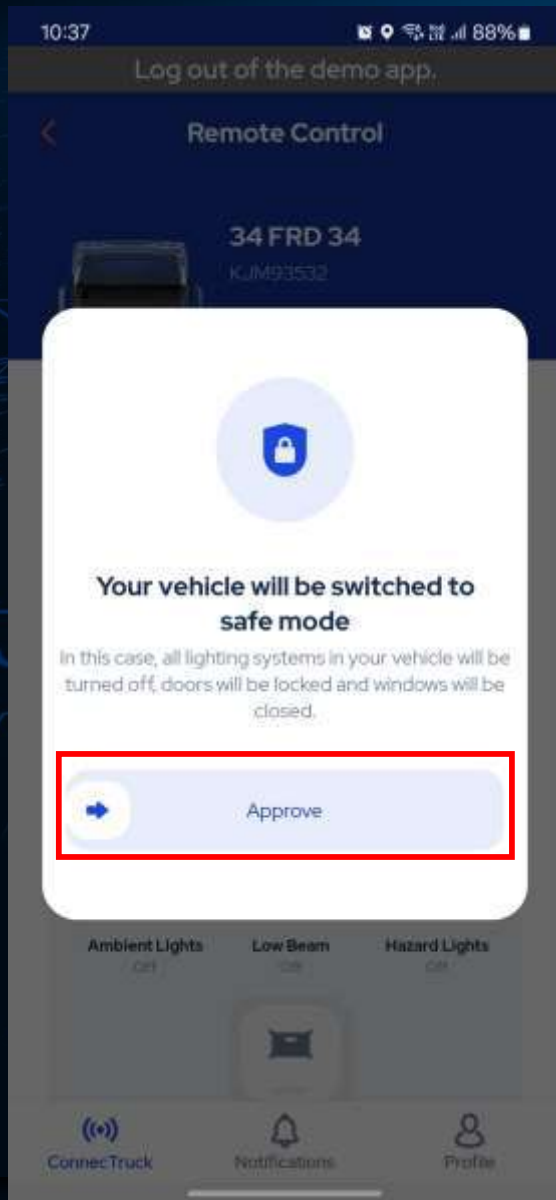
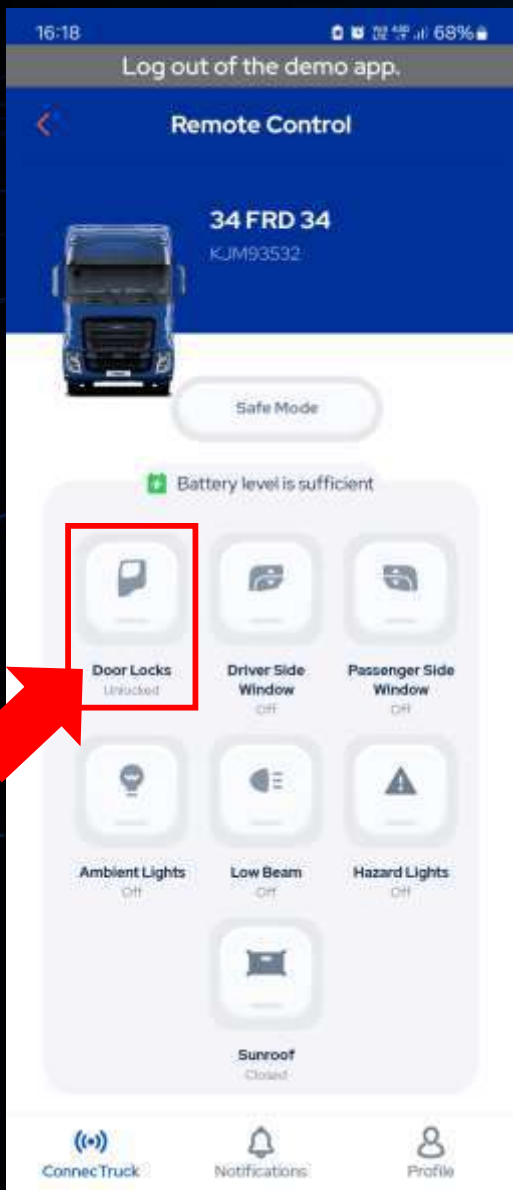

Click the "Safe Mode" button to put your vehicle in safe mode. In this mode, your vehicle's doors will be locked, and the windows and lights will be turned off.

CONNECTRUCK

Vehicle Usage Reports



Click on the «**Reports**» tab to receive the usage of your vehicles as e-mail in PDF format.

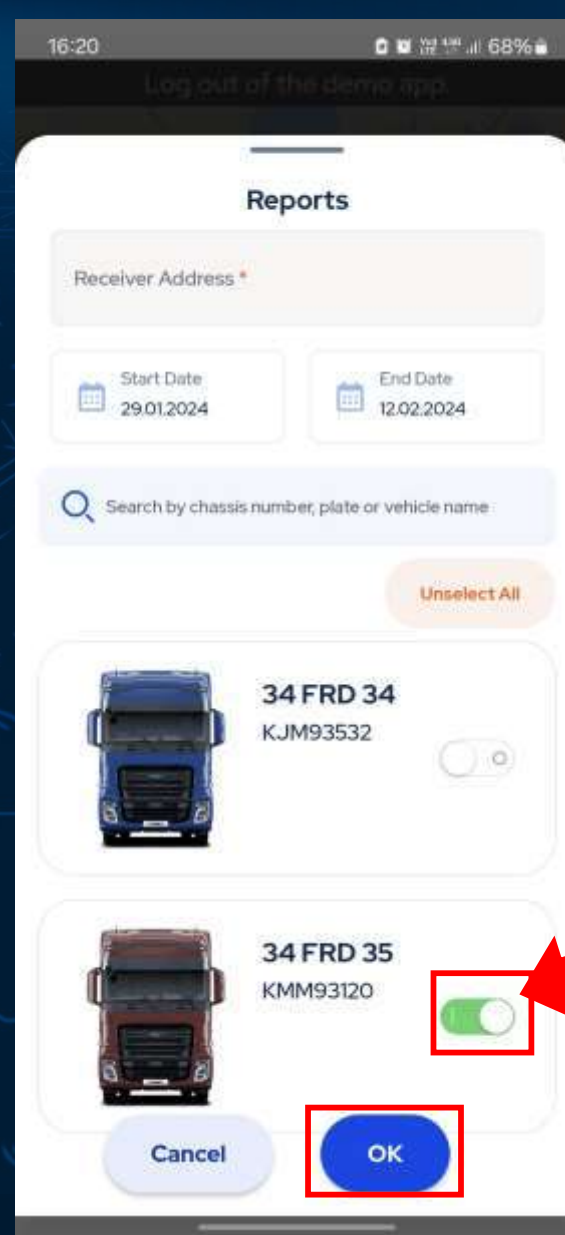
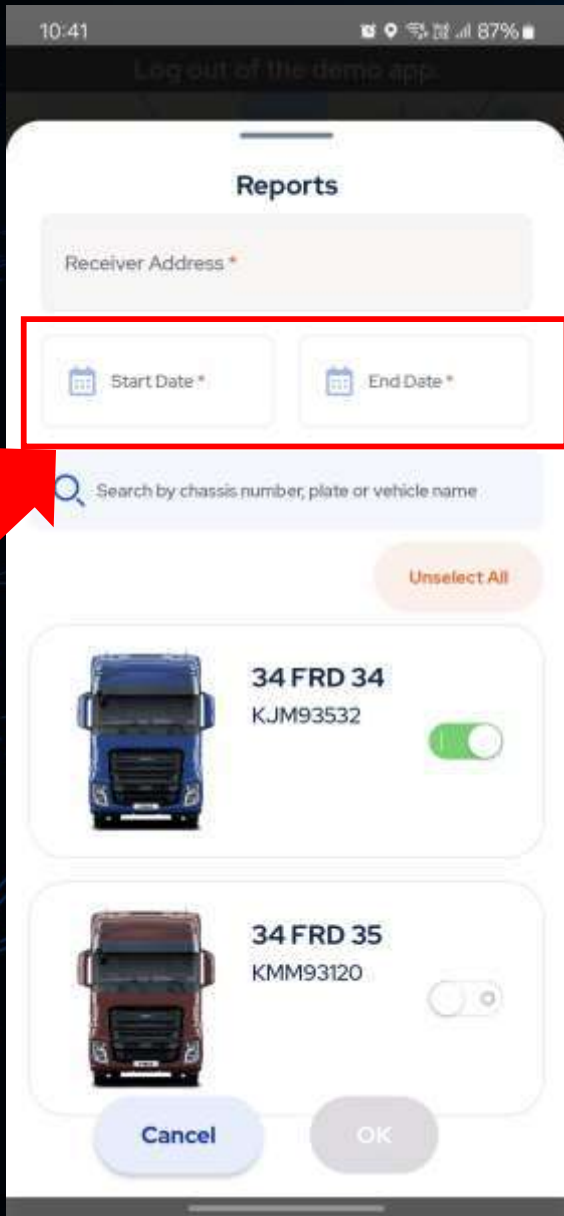





After selecting the date and vehicles you want to receive the report on the screen that opens, click "OK".



Vehicle Summary Report

Date Range : 01/11/2023 - 01/01/2024

Number of vehicles : 1

Chassis No	 Average Fuel Consumption (l/100 km)	 Trip Distance (km)	 Average Vehicle Speed (km/h)	 Engine Working Hours (h)	 Axle Load (t)	 Average Urea Consumption (l/100 km)	 Total Distance (km)	 Idle Rate* (%)	 MaxCruise Usage Rate** (%)	 Cruise Control Usage Rate** (%)
NM0KCXTP6KNG92249	28.2	655	22.9	21.2	3.2	0.0	22,646	36.7	2.7	2.7
Average	28.2	655	22.9	21.2	3.2	0.0	-	36.7	2.7	2.7

Report in PDF format will be sent to your email within 10 minutes.